



## Plastic Bottle Unscrambler

### NECOSORT

Accepts bottles from a random bulk supply and single files them onto a discharge conveyor.



NECOSORT-54-BH



NECOSORT-96 with 70 Cubic Foot Bulk Hopper

*Nalbach Engineering's NECOSORT Plastic Bottle Unscrambler reduces maintenance and downtime.*

The NECOSORT plastic bottle unscrambler sorts a wide range of rigid container shapes, including rounds, ovals, squares and rectangulars. Easy release clamps and unitized change parts make changeovers a fast and simple operation allowing a single employee with no special skills to complete a changeover in twenty minutes or less. Designed with only two moving parts, virtually eliminating downtime, the NECOSORT carries a three (3) year warranty!

Container Orienters can be incorporated to align containers with offset necks, handles, and odd shapes. Line Combiners can also be added to create a Dual NECOSORT Unscrambler system for increased production rates.

#### Benefits

- With no reciprocating motions, complicated mechanisms or hard to adjust container handling parts, maintenance and downtime is virtually eliminated.
- Stainless steel change parts and other bottle contact parts provide for exceptional durability.
- Stainless steel machine and change parts insure no particulate matter is created making the NECOSORT suitable for clean room operation.
- Large number of pockets permits slow sorting of each individual bottle, providing for remarkably gentle product handling, minimizing the chances of damage.
- Designed to work with differing numbers of "chutes", each set of change parts is optimized for maximum performance and throughput for each bottle size.
- Unitized change parts for major bottle changes results in a minimum of changeover time.
- The "BH", model includes an integral bulk hopper and elevator.
- Designed with only two moving parts, virtually eliminating downtime, the NECOSORT carries a three-year warranty.

#### About Nalbach Engineering Company

Founded in 1945, our Company has earned its dominant reputation for quality and performance in the design and manufacture of a complete line of plastic bottle unscramblers and powder filling equipment. In addition, we offer aerosol fillers, turnkey packaging lines, and system integration services. A member of PMMI since 1958, Nalbach Engineering has developed equipment for a widely diverse client roster of Blue Chip companies and has installed systems in 45 countries around the globe.



## Dimensions

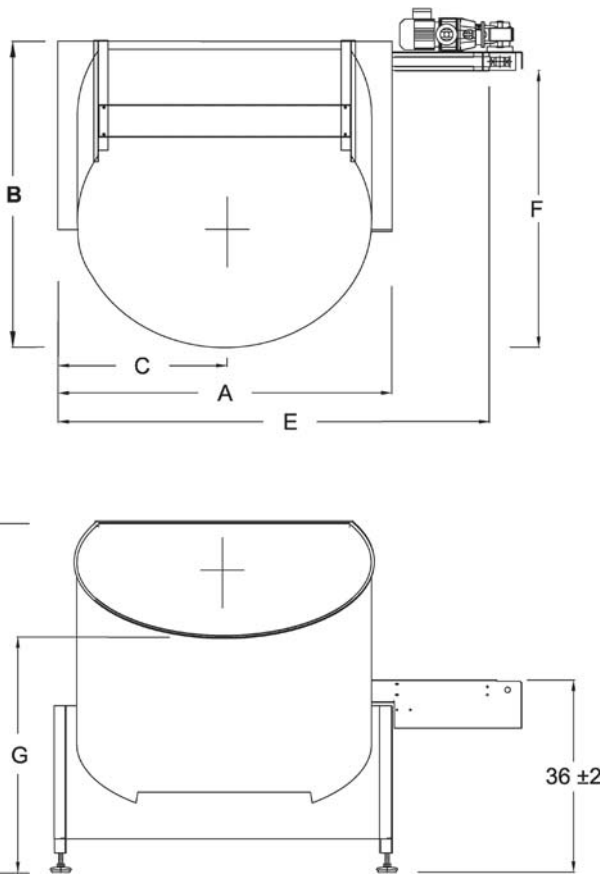

Dimensions (inches)	Machine Model Numbers						
	NS-36	NS-54	NS-72	NS-85	NS-96	NS-105	NS-130
A	42	60	82	90	103	109	135
B	38 ½	64	77	80½	91½	100	137½
C	21	30	41	45	51½	54½	67½
D ±2	58	68¾	70½	71½	88½	89½	100
E	74	92	115	115	127	133	159
F	34 ½	53	65	75	89 ½	90	130
G ±2	40	41	42	43	42	44	44

Specifications subject to change without notice.

## Machine Operation

The machine consists of a drum with a stationary floor that is inclined at a 30-degree angle. Around the outside edge of the floor is a series of moving pockets or chutes, which will accept your bottle and carry it to the high side of the drum. At this point, the bottle is oriented bottom down and placed in a chute to be discharged on a built-in and synchronized conveyor.

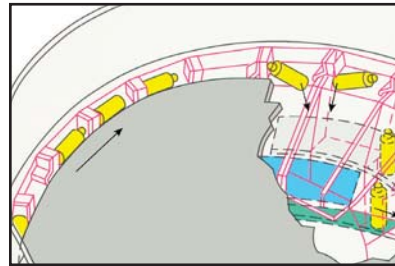

## Specifications

### Electric and Controls

#### Electrical:

System voltage and frequency configured to meet customer specifications

#### Electrical Controls:

Digital Solid State

#### Speed and Container Size Range

See Chart below

#### Construction

**Stainless steel machine and change parts**

#### Optional Accessories

#### Line Combiners:

Independent line combiners to merge the output of two (2) machines

#### Orienters:

For off-center neck bottles or bottles with handles

#### Discharge Direction:

Left hand or right hand bottle discharge

#### Conveyors:

Conveyor extensions or modifications to fit your line

#### Bulk Hopper & Elevator:

35 cubic foot integral bulk hopper, 40 cubic foot bulk hopper or 70 cubic foot bulk hoppers available

#### Bulk Handling Systems:

Complete automated bulk handling systems

Bottle Handling Capacities and Speeds

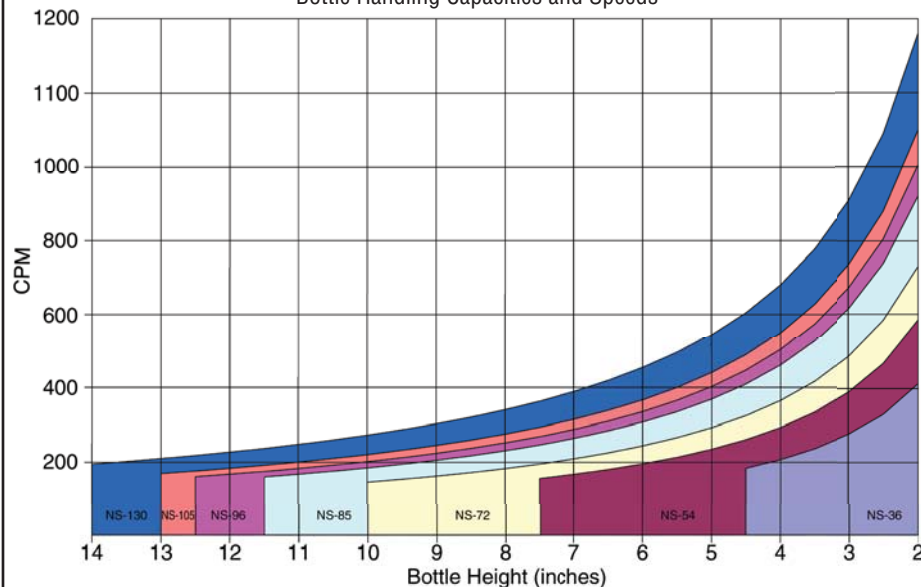

Chart provides an indication of the container handling speeds of each model for round containers. Ask your Nalbach representative for exact speeds based on your container shape and size.

## Nalbach Engineering Company, Inc.

621 East Plainfield Road, Countryside, IL 60525 U.S.A.

Phone: 708/579-9100 • Fax: 708/579-0122

www.nalbach.com

© 2009 Nalbach Engineering Company, Inc.

